

---

# **Elektra Evok**

## **Software update procedure**

---

From version 1.5 to 1.6

## Summary

Display and master update.....	3
WiFi connection to the machine (PC Windows).....	4
WiFi interface update .....	5
Installed version checking (via WiFi) .....	5
Recovery interface.....	6

## Display and master update

- Turn off the machine
- Remove the display
- Remove the SD
- Copy all the files, included into the folder of the new version, to the SD
- Connect the SD and re-assemble the display
- Switch on the machine: the procedure update starts
- Wait until the software update is completed, the display restarts
- When the clock is shown the machine can be switched off

## WiFi connection to the machine (PC Windows)

The local WiFi hotspot of the machine generates a network called

**CoffeeUI-<serial number>**

- Connect to the WiFi **CoffeeUI-XXX** and enter the password **12345678**
- Once the connection is made, the browser will automatically open on the WiFi interface of the machine
- If the browser doesn't start automatically (depending on the device or the operating system version), using your browser (Chrome if possible) go to <http://coffeeui.local> or <http://192.168.4.1>

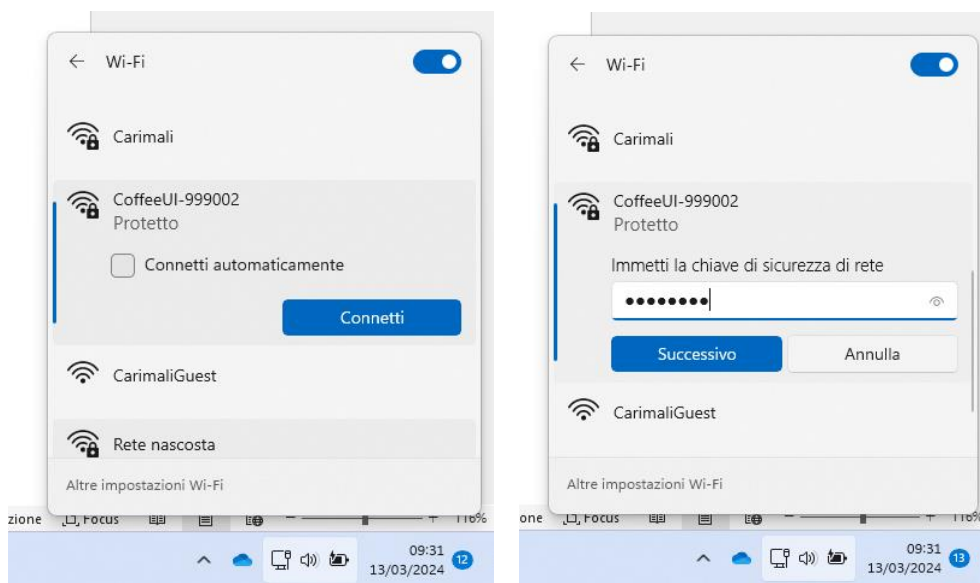

### NOTE:

The number of simultaneous WiFi connections is limited to a maximum of 3.

During update procedures, it is preferable that only one PC is connected to the machine.

### CAUTION:

During the first set up of the machine, the serial number is not set and the WiFi takes on a different name (CoffeeUI- followed by a random alphanumeric code).

Once the serial number has been set, it is necessary to reboot the machine to update the WiFi name.

In addition, in order to allow to the PC to recognise the new WiFi name it may be necessary to restart the PC's WiFi and reboot the machine one or more times.

## WiFi interface update

1. Switch the machine on and leave it in standby
2. Connect to the machine's WiFi (see previous paragraph)
3. Access to the web page <http://192.168.4.1>
4. From the bottom bar, click on the login icon (the first on the left)
5. Log in with the 5-digit pin
6. Click on the settings button
7. Go to the menu SETTINGS -> UPDATES
8. If necessary, click on the LOCK button
9. In the field WiFi firmware upgrade, select "WiFi\_xxx.zip"
10. Click on the upload icon
11. Wait for the operation to complete.
12. On completion, disconnect from WiFi
13. If necessary, reconnect and check functionality.

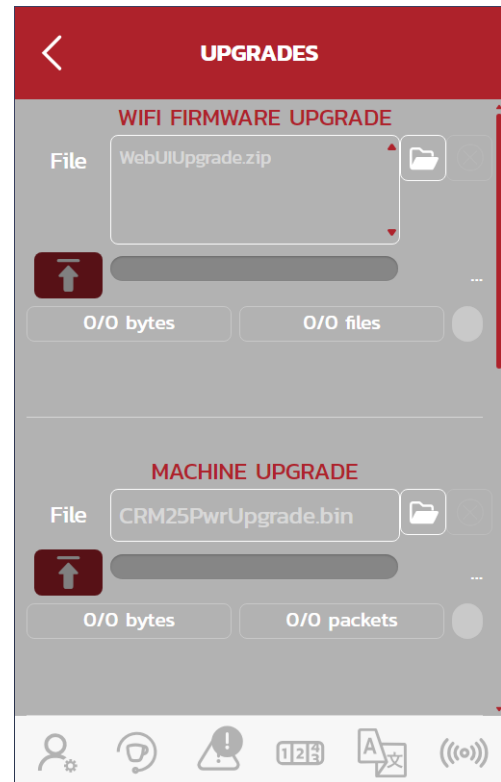

## Check of installed versions (via WiFi)

- Switch on the machine
- Connect to the machine's WiFi (see dedicated section)
- Access the web page <http://192.168.4.1>
- From the bottom bar, click on the login icon (first on the left)
- Log in with the 5-digit pin
- Click on the settings button
- Access the INFO menu

## Recovery interface

The WiFi module software consists of two parts:

- the firmware (FW) that constitutes the functional part of the connection with the machine
- the filesystem where the functions and graphics of the user interface (UI) reside

First of all, extract the two files **firmware.bin** and **littlefs.bin** from “WiFi\_xxx.bin”.

Even in the absence of the filesystem, there is still a recovery interface available that allows you to update or restoring FW and UI operations.

The recovery interface is accessible at <http://coffeeui.local/admin/recovery/main.html>

Once logged in using the 5-digit PIN, access is given to the recovery functions.

The image displays three sequential screenshots of the 'Coffee UI - Recovery' web interface. The first screenshot shows a 'Login' screen with a 'Password:' label and a text input field, followed by a teal 'Login' button. The second screenshot shows the 'Restart WiFi Module' section with a teal 'Reset' button, and below it, the 'WiFi Hot Spot' section with 'AP SSID:' and 'Password:' labels, input fields, a teal 'Change' button, and a teal 'Restore default' button. The third screenshot shows the 'FW version' section with 'Build commit ID: 5144ba7f18cd0abdfb211f01d907c13d7e32e0d' and 'FW Version: v0.0.1-72-g5144ba7-dirty', followed by the 'UI version' section with 'UI commit ID: 5144ba7f18cd0abdfb211f01d907c13d7e32e0d' and 'UI Version: v0.0.1-72-g5144ba7-dirty', and a teal 'Upgrade' button.

Clicking on the Upgrade button takes you to the page for the OTA (Over The Air) update.

- Select 'Firmware' type
- Select the 'firmware.bin' file to be used for the update
- Wait for the operation to complete.
- On completion, disconnect from WiFi and reconnect
- Log back onto <http://coffeeui.local/admin/recovery/main.html>
- Click on Upgrade
- Select the "Filesystem" type
- Select the "littlefs.bin" file to be used for the upgrade
- Wait for the operation to complete

